



21 Romney Road, Walderslade, Kent, ME5 7LU

VIRTUAL TOUR AVAILABLE**TWO DOUBLE BEDROOMS**LOUNGE**FITTED KITCHEN**CONSERVATORY**DRIVE WAY**PORCH**

Fantastic first time buyers semi detached house with a block paved drive has just hit the sales market and wont be available long. The property is situated in the village of Walderslade and has so much to offer, call us today to book your internal viewing. A handy porch with a storage cupboard leads you to the good sized and tastefully decorated lounge. To the rear, is a very well equipped fitted kitchen with granite work tops and is open to a fantastic conservatory that looks out to the rear garden. To the first floor there are two double bedrooms and a family bathroom, The rear garden is split level with side access to the front which leads to the block paved drive. There is also a front garden which is mainly lawn. Added benefits include gas central heating and double glazed windows.

Walderslade is a great place to start looking for homes in North West Kent. Ideally located for those wanting to explore further afield and still enjoying a full range of local amenities including schools, shops and motorway links, so don't miss out on your opportunity to view

- 2 DOUBLE BEDROOMS
- LOUNGE
- FITTED KITCHEN
- CONSERVATORY
- COUNCIL TAX BAND C
- DRIVEWAY FOR 1 CAR
- DOUBLE GLAZED WINDOWS
- CENTRAL HEATING
- REAR GARDEN

£295,000

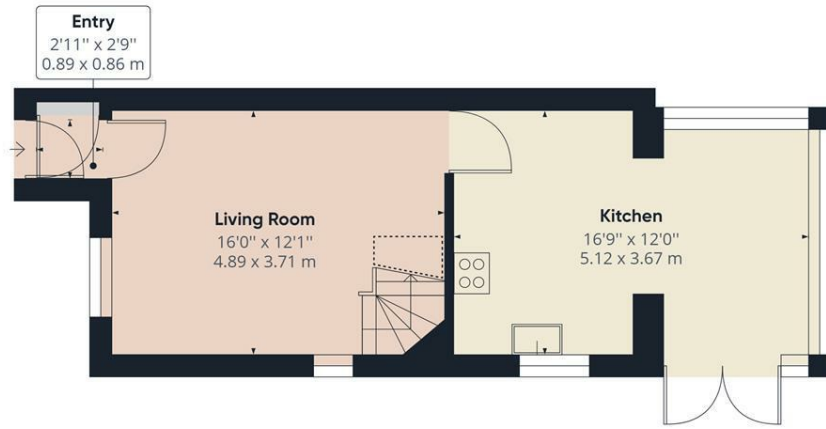

Ground Floor Building 1

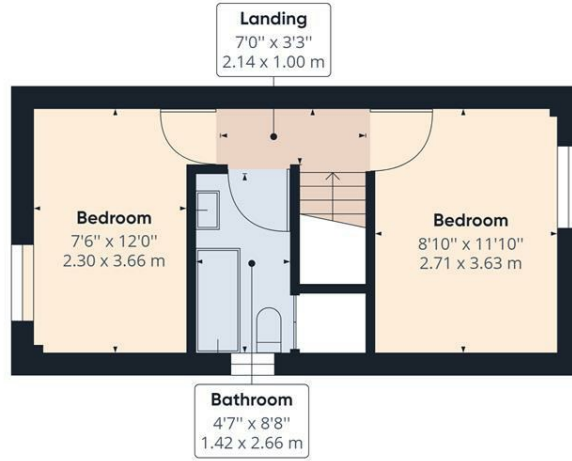

Floor 1 Building 1

Approximate total area⁽¹⁾

678.73 ft²
63.06 m²

Reduced headroom

6.88 ft²
0.64 m²

(1) Excluding balconies and terraces.

Reduced headroom
(below 1.5m/4.92ft)

While every attempt has been made to ensure accuracy, all measurements are approximate, not to scale. This floor plan is for illustrative purposes only.

GIRAFFE360

